



workstories...

ASSEMBLY GUIDE

ALBION

Desking
—
Hub

info@workstories.com
+44 (0)20 3735 5224
workstories.com

hub / end leg frames

tool required

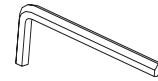

5mm
allen key



Pozi
screw driver

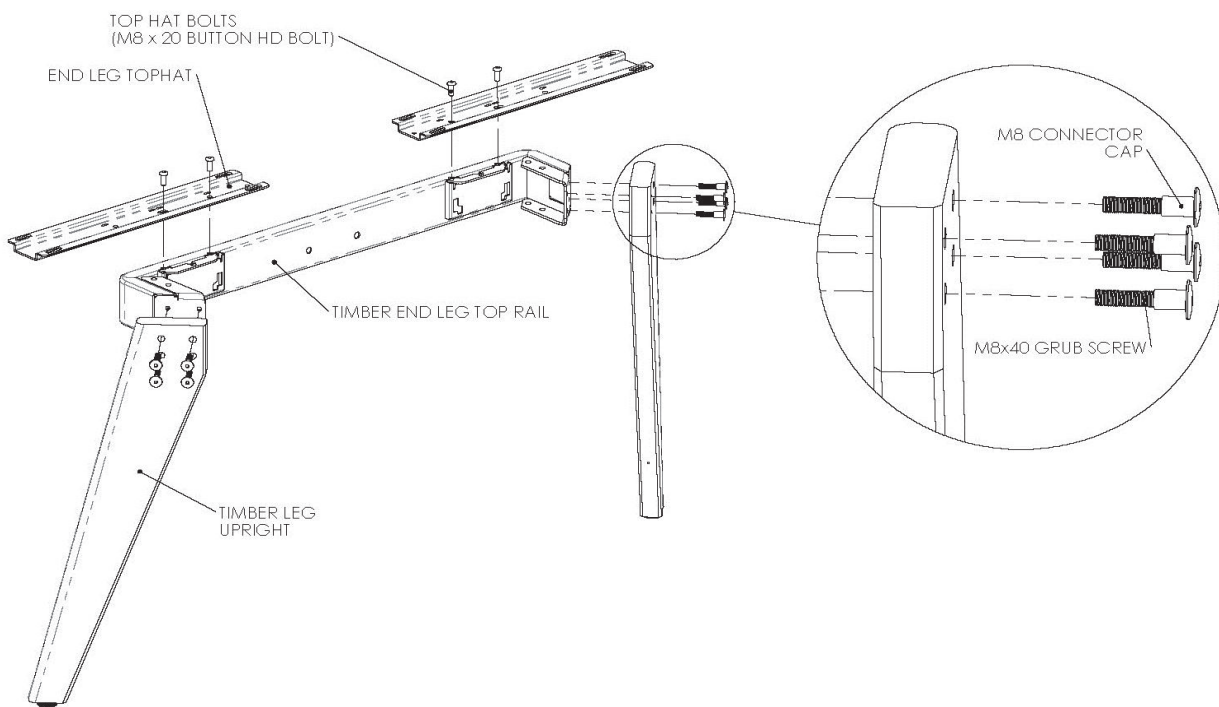

- Offer the timber leg components up to the end leg toprail and bolt in place with M8 connector caps & M8x40 grub screws through timber leg. Note - the M8 connector caps should be wound fully onto the M8x40 grub screws before fitting
- Tophats can be bolted into position using M8x20 button HD bolts once the telescopic beams have been fitted

hub / intermediate leg frames

tool required

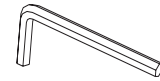

5mm
allen key



Pozi
screw driver

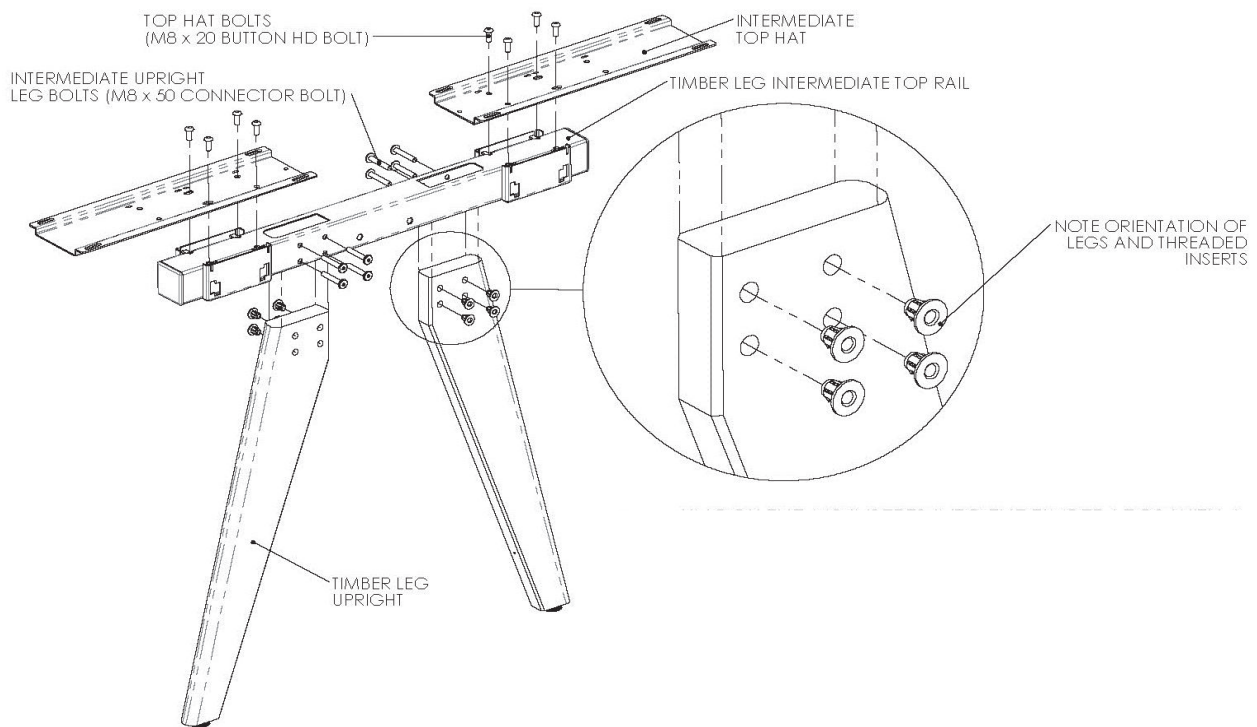

- Knock the M8 inserts into the timber legs with a hammer or hard mallet, noting the orientation
- Slot the timber leg components up through the bottom of the intermediate top rail and bolt in place with M8x50 connector bolts through top rail
- Tophats can be bolted into position using M8x20 button HD bolts once the telescopic beams have been fitted

single desk

tool required



4/5mm
allen key



Pozi
screw driver



Rubber
mallet

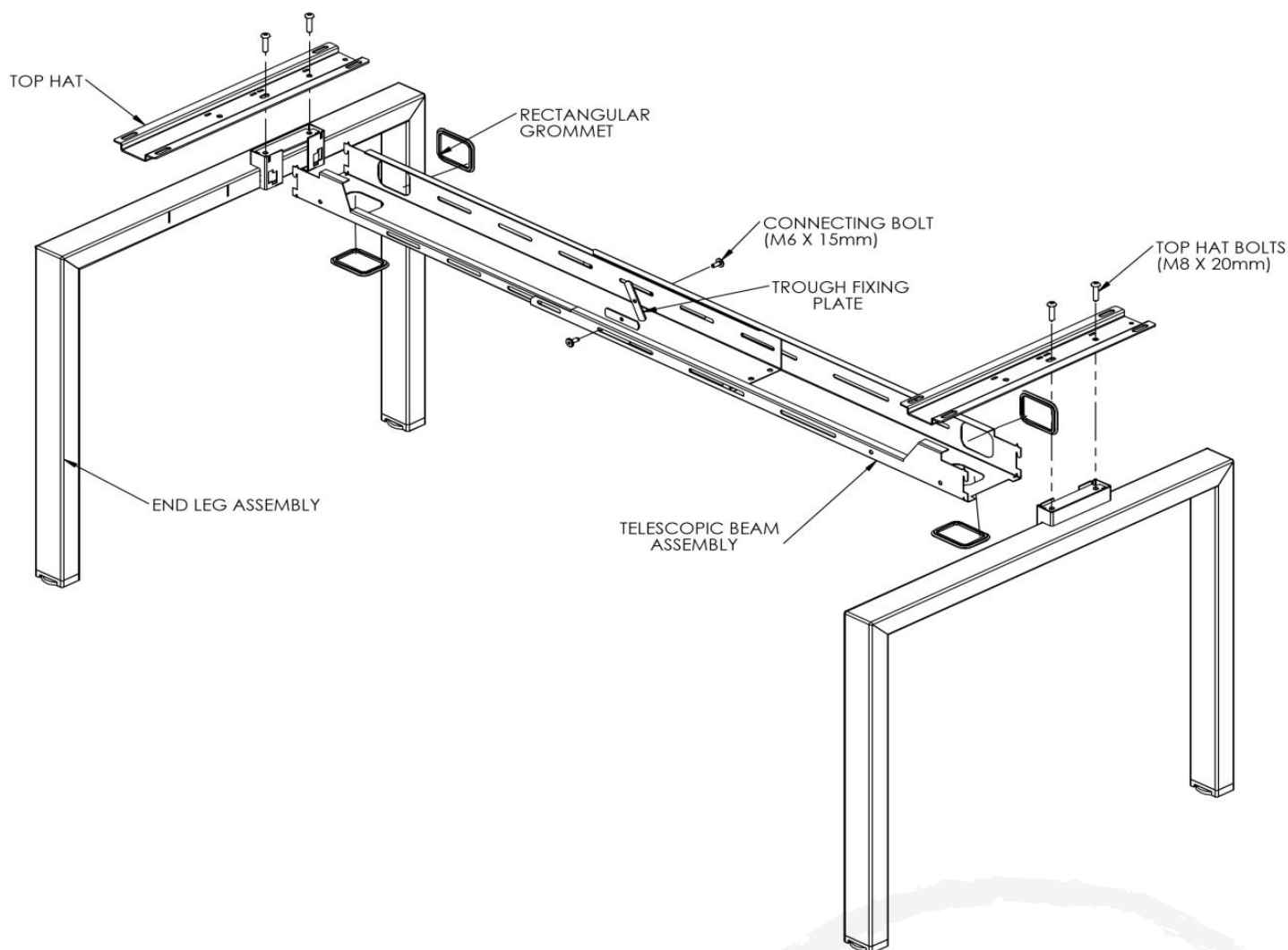

HUB FRAME ASSEMBLES THE SAME WAY AS GOALPOST SHOWN ABOVE

- Insert all cable grommets and feet
- Insert one end of telescopic beam into end leg (do not fix top hats) - at this point a rubber mallet may be required to knock beam into position (take care not to damage beam)
- Repeat with other end leg
- Secure top hats with bolts provided and tighten
- Slide beams to approx distance required to suit top length
- Hold trough fixing plates on inside of trough and screw in connecting bolts through slots provided and tighten
- Use fixings supplied with top hats to fix top

bench / no intermediate leg

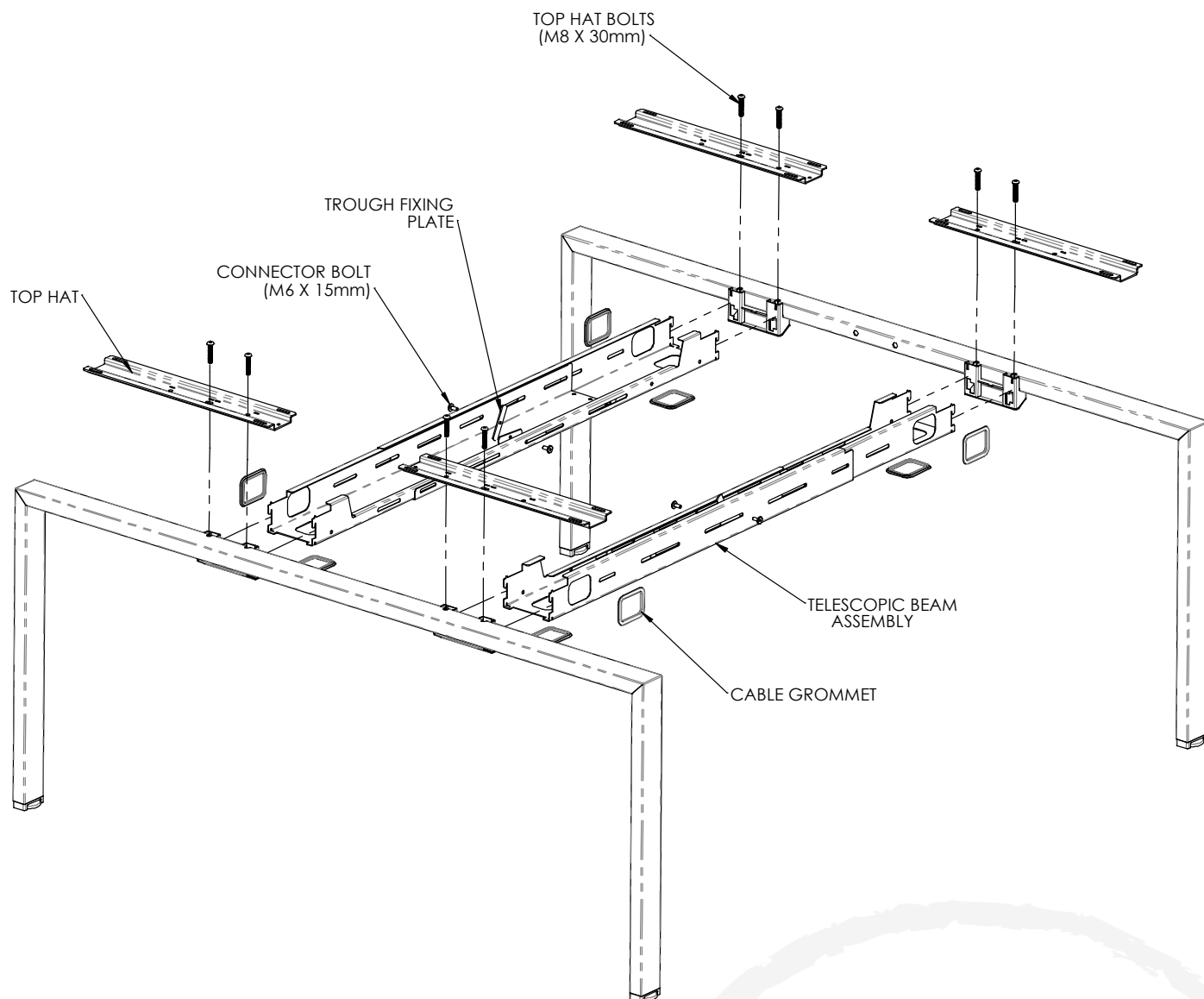
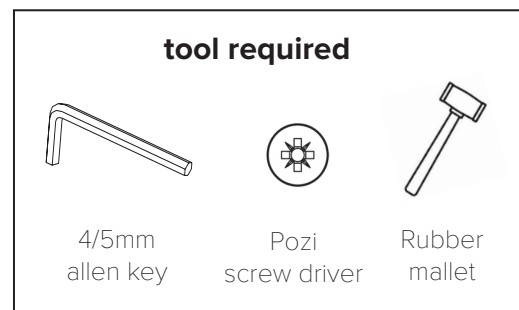

HUB FRAME ASSEMBLES THE SAME WAY AS GOALPOST SHOWN ABOVE

- Insert all cable grommets and feet
- Insert one end of telescopic beam into end leg (do not fix top hats) - at this point a rubber mallet may be required to knock beam into position (take care not to damage beam)
- Repeat with other end leg
- Secure top hats with bolts provided and tighten
- Slide beams to approx distance required to suit top length
- Hold trough fixing plates on inside of trough and screw in connecting bolts through slots provided and tighten
- Use fixings supplied with top hats to fix top

bench / with intermediate leg

tool required



4/5mm
allen key



Pozi
screw driver



Rubber
mallet

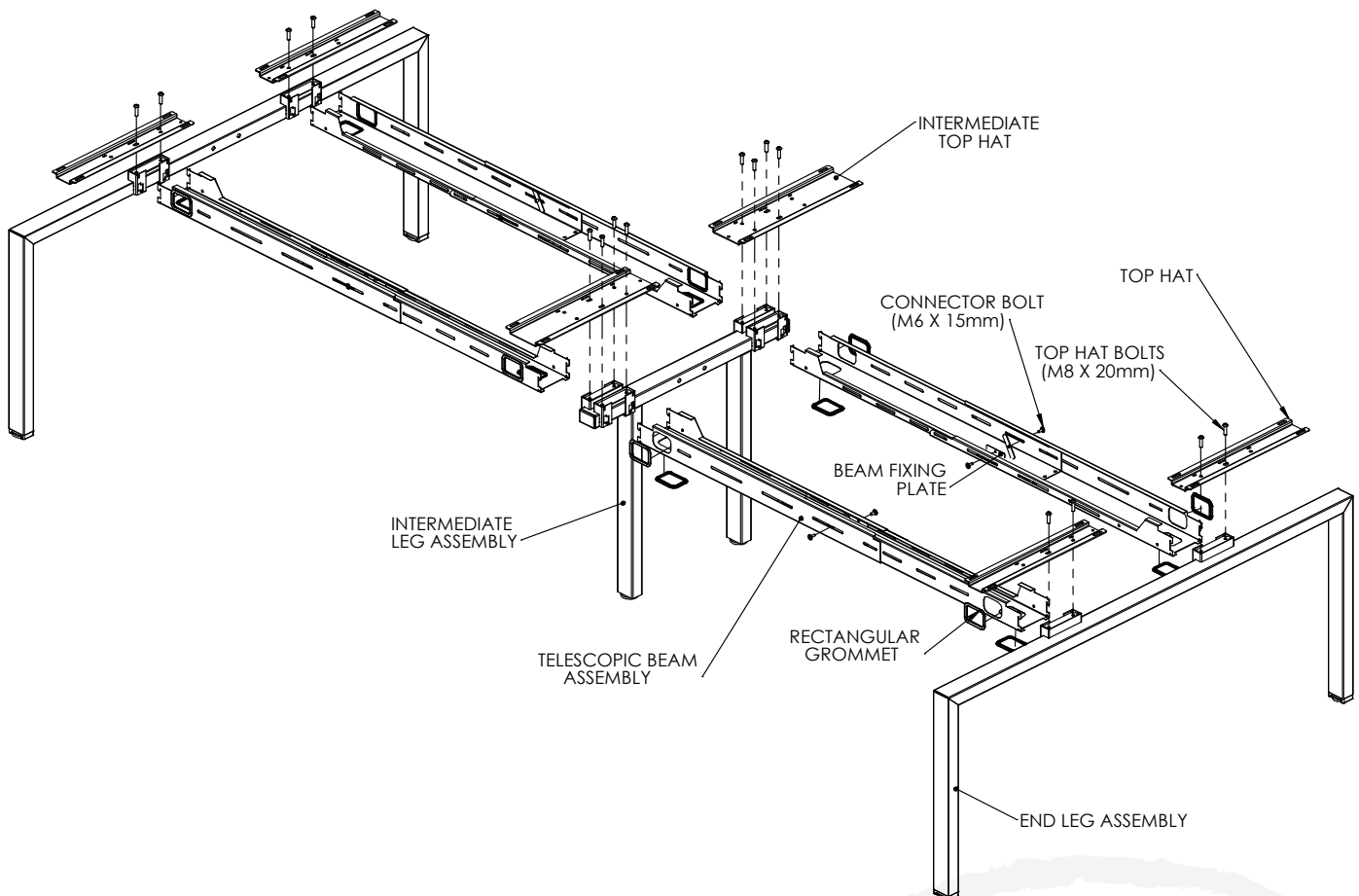

HUB FRAME ASSEMBLES THE SAME WAY AS GOALPOST SHOWN ABOVE

- Insert all cable grommets and feet
- Insert one end of telescopic beam into end leg (do not fix top hats) - at this point a rubber mallet may be required to knock beam into position (take care not to damage beam)
- Repeat with intermediate leg, and then with other end leg
- Secure top hats with bolts provided and tighten
- Slide beams to approx distance required to suit top length
- Hold trough fixing plates on inside of trough and screw in connecting bolts through slots provided and tighten
- Use fixings supplied with top hats to fix top



SHOWROOM

13 Northburgh Street,
London EC1V 0JP

CONTACT

Info@workstories.com
+44 (0)20 3735 5224

workstories.com